

PROJECT
삼육대학교
제1실습관 교육실
404호



CLIENT

INTERIOR ARCHITECTURE

실면적	57.16 m ²
6인 양면 열람대	21EA
6인 양면 열람대	36EA

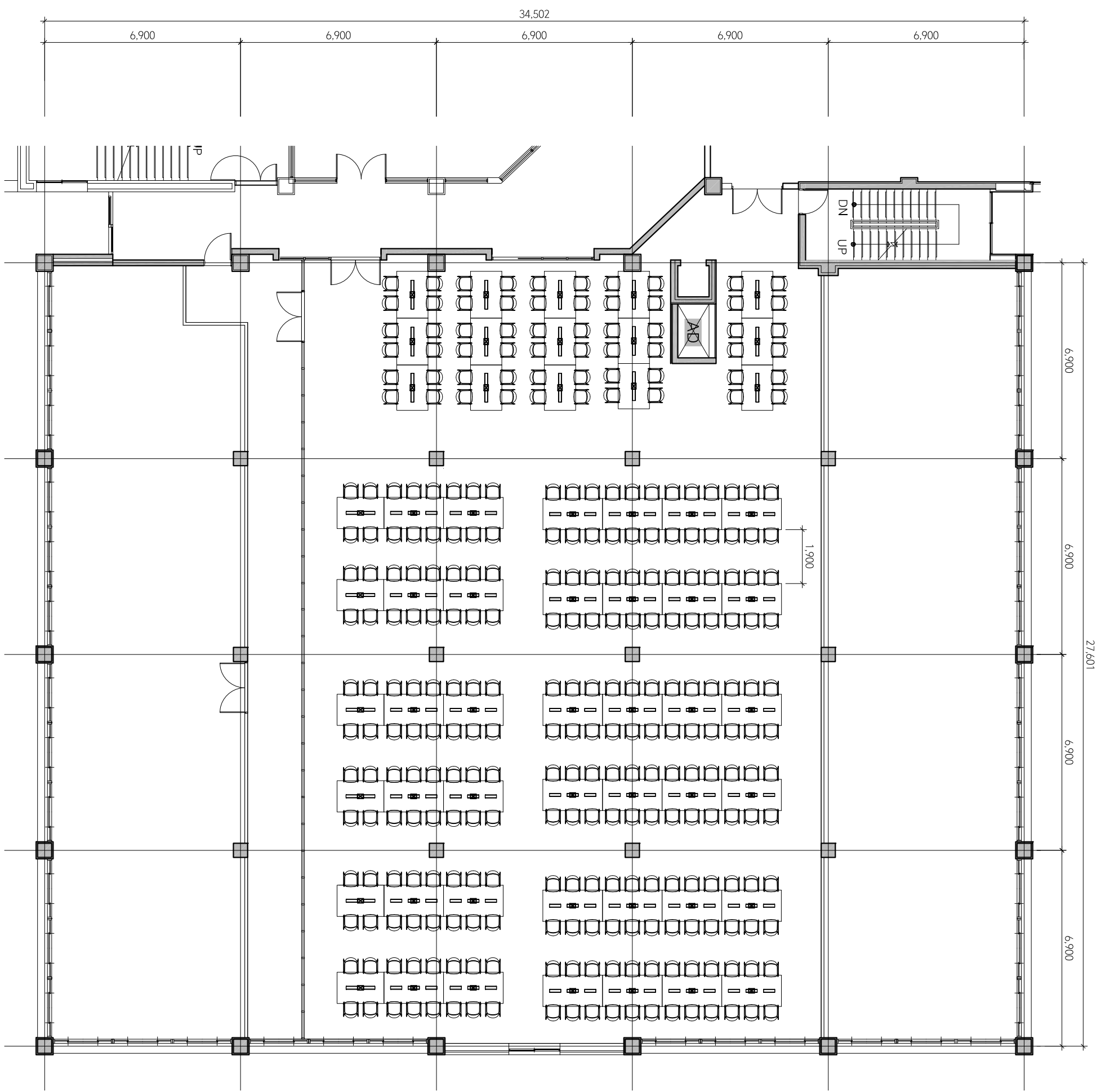

NOTE

REVISIONS	DATE	REMARK
△		
△		

SHEET TITLE:

FLOOR PLAN
도서관3층

DRAWN BY

CHECKED BY

SCALE

DATE

DRAWING NO

SHEET NO

SCALE
A3:1/150

#-101

006

1 FLOOR PLAN - 도서관3층

PROJECT
삼육대학교
제1실습관 교육실
404호



CLIENT

INTERIOR ARCHITECTURE

바닥재(바닥재)기box	57.16 m ²	64 EA
3인 단면 열람대	2200*750*745	7EA
4인 양면 열람대	1650*750*745	21EA
6인 양면 열람대	2100*750*745	36EA

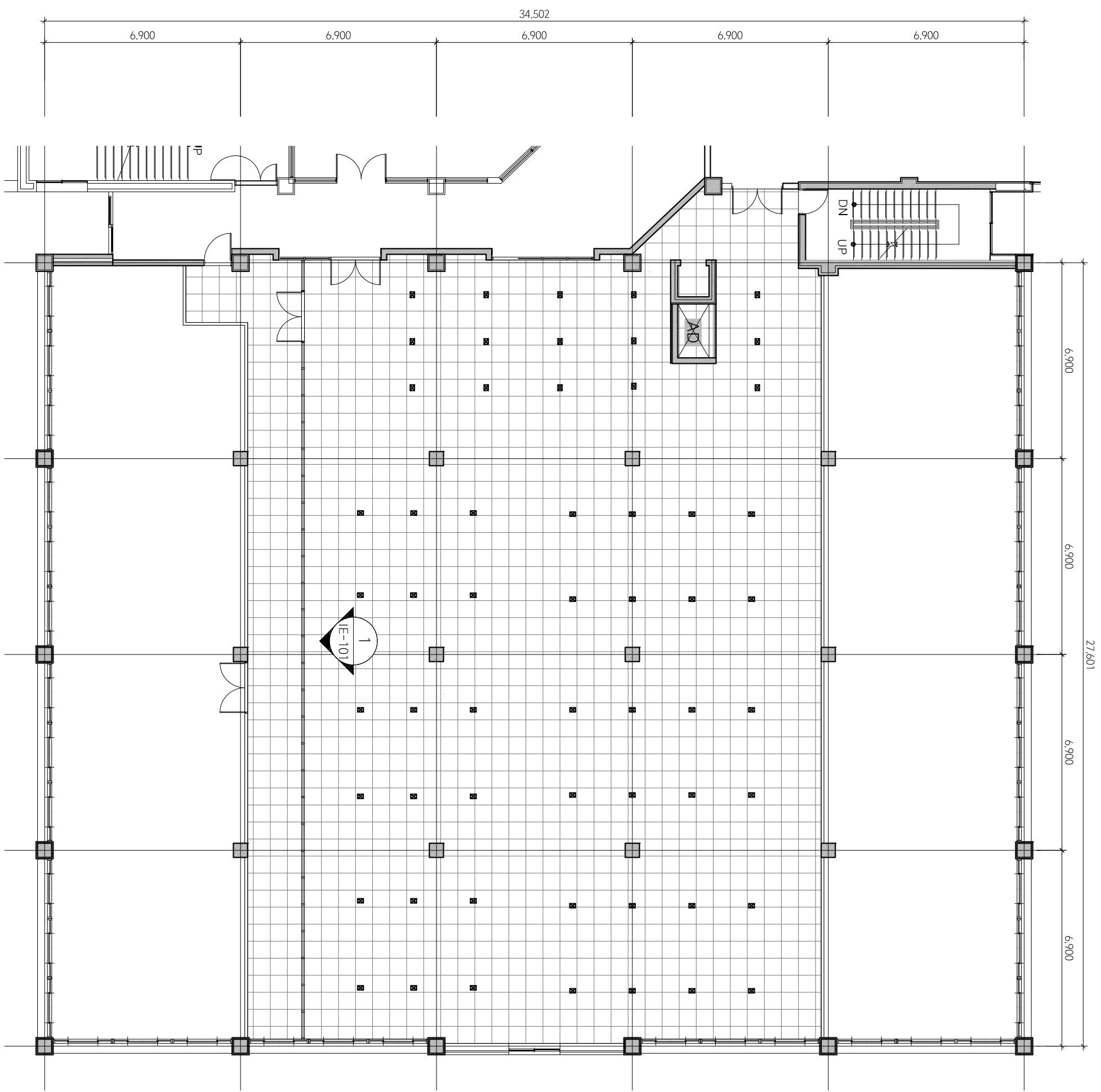

NOTE

REVISIONS	DATE	REMARK
△		
△		
△		
△		
△		
△		
△		
△		
△		
△		

SHEET TITLE:
PATTERN PLAN
도서관3층

DRAWN BY	CHECKED BY	SCALE	DATE	DRAWING NO	SHEET NO
		A3:1/150	2020 - 01		

SCALE
A3:1/150

1 PATTERN PLAN - 도서관3층

PROJECT
삼육대학교
제1실습관 교육실
404호



CLIENT

INTERIOR ARCHITECTURE

NOTE

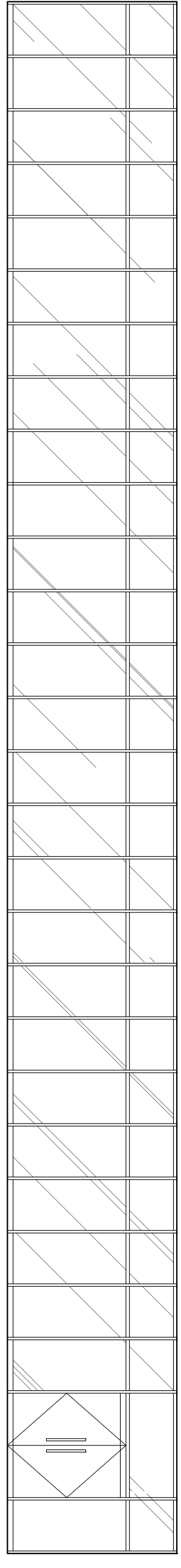
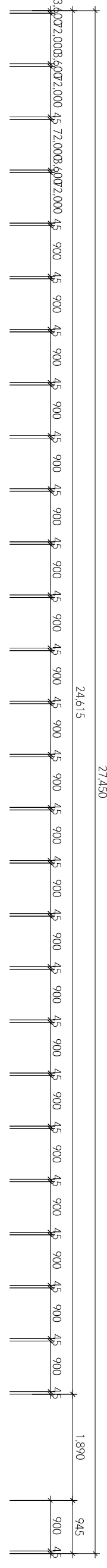

REVISIONS	DATE	REMARK
△1		
△2		

SHEET TITLE:
ELEVATION - 01

DRAWN BY
 CHECKED BY
 SCALE A3:1/80
 DATE 2020 - 01
 DRAWING NO
 SHEET NO 006

1 ELEVATION - 1 SCALE A3:1/80